

Twin Polarization Insensitive Isolator

Features

Low Insertion Loss
 High Isolation
 Excellent Temperature Stability
 Low Temperature Dependence

Applications

EDFA
 Instrumentation
 Fiber Lasers
 Research

Specifications

Parameters	Unit	Values			
		Single Stage		Dual Stage	
Grade		Grade P	Grade A	Grade P	Grade A
Center Wavelength	nm	1310, 1480 or 1550			
Operating Wavelength Range	nm	±20			
Typ. Peak Isolation (Port 4 to Port 1, Port 3 to Port 2)	dB	42	40	58	55
Min. Isolation (Port 4 to Port 1, Port 3 to Port 2) at 23°C	dB	28	26	48	45
Typ. Insertion Loss (Port 1 to Port 4, Port 2 to Port 3) at 23°C	dB	0.45	0.55	0.55	0.7
Max. Insertion Loss (Port 1 to Port 4, Port 2 to Port 3) at -5°C-70°C	dB	0.65	0.75	0.75	0.9
Min. Return Loss (Input/Output)	dB	55 / 55	55 / 55	55 / 55	55 / 55
Min. Directivity (Port 1 to Port 2, Port 3 to Port 4) at 23°C	dB	55	55	55	55
Min. Crosstalk (Port 1 to Port 3, Port 2 to Port 4) at 23°C	dB	50	50	55	55
Max. PDL at 23°C	dB	0.05	0.1	0.05	0.15
Max. PMD	ps	0.2 ¹	0.25 ¹	0.05	0.07
Max. Optical Power (CW)	mW	500			
Max. Tensile Load	N	5			
Fiber Type		SMF-28e Fiber			
Operating Temperature	°C	-5 to +70			
Storage Temperature	°C	-40 to +85			

¹PMD<0.05ps is available. Please refer to below ordering information.

*Above specifications are for device without connector.

*For devices with connectors, IL will be 0.3dB higher and RL will be 5dB lower.

Package Dimensions

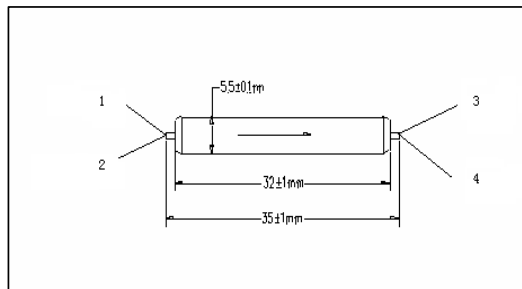
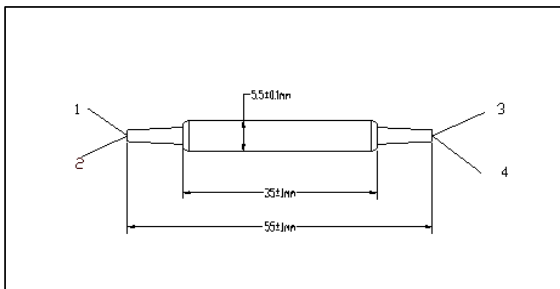

Ordering Information

ATPII-1 ①①-②-③-④-⑤⑤⑤⑤-⑥⑥⑥⑥-⑦-⑧

①①: Wavelength

31 - 1310nm

48 - 1480nm

55 - 1550nm

SS - Specify

②: Grade

P - Premium Grade

A - A Grade

③: Stage

S - Single Stage

D - Dual Stage

④: PMD

1 - 0.05ps Max

2 - Refer to above Spec.

⑤⑤⑤⑤: Connector Type on Port 1, 2, 3 & 4

1 - FC/UPC

2 - FC/APC

3 - SC/UPC

4 - SC/APC

N - None

S - Specify

⑥⑥⑥⑥: Fiber Jacket on Port 1, 2, 3 & 4

B - 250um Bare Fiber

L - 900um Loose Tube

⑦: Fiber Length

1 - 1.0m

S - Specify

⑧: Package Length

1 - 35mm

2 - 32mm