

Bandpass Filter

Features

High Isolation
 Low Insertion Loss
 High Return Loss
 Excellent Environmental Stability

Applications

Fiber Lasers
 Amplifiers

Specifications

Parameters	Unit	Values
Center Wavelength	nm	1064
Max. Insertion Loss over CWL \pm 2.5nm	dB	0.8
Min. Pass Bandwidth at 0.5dB	nm	5
Max. Stop Bandwidth at 25dB	nm	22
Max. PDL	dB	0.1
Min. Optical Return Loss	dB	50
Max. Optical Power(CW)	mW	300
Max. Tensile Load	N	5
Fiber Type		HI 1060 Fiber
Operating Temperature	$^{\circ}$ C	-5 to +70
Storage Temperature	$^{\circ}$ C	-40 to +85

*Above specifications are for device without connector.

*For devices with connectors, IL will be 0.3dB higher, RL will be 5dB lower.

Package Dimensions

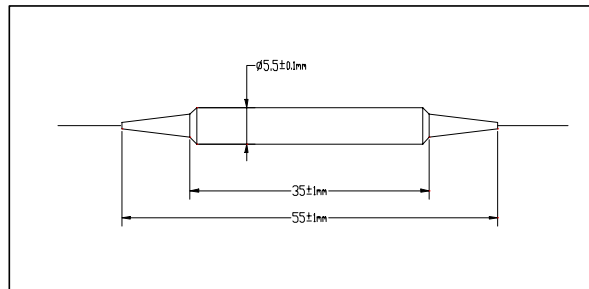

Ordering Information

ABPF-①①①①-②②-③③-④-⑤-⑥

①①①①: Center Wavelength

06- 1064nm

SSSS - Specify

②②: Pass Band Width

05 - 5nm

SS - Specify

③③: Stop Band Width

22 - 22nm

SS - Specify

④: Connector Type for port 1 & 2

1 - FC/UPC

2 - FC/APC

3 - SC/UPC

4 - SC/APC

N - None

S - Specify

⑤: Fiber Jacket for port 1 & 2

B - 250um Bare Fiber

L - 900um Loose Tube

C - 3mm Cable

S - Specify

⑥: Fiber Length

1 - 1.0 m

S - Specify